

Saxon Blinds Ltd

Specifications



65mm System

Drive End Features:

- A smooth-running chain drive can be operated with nickel N° 10 chain
- Internal mechanisms are coated with tailored lubricant ensuring smooth and quiet operation.

Bracket Features:

- Load Capacity 12.0Kg
- Heavy-duty 3mm thick steel, plated for rust resistance.
- Plastic cover caps available to finish blinds when fitted outside the recess.

Free End:

- A secure and positively locked pin end for easy installation of the blind or the option of coupling up to three blinds from one drive

Roller Tube:

- High Quality 65mm internal webbed extruded aluminium dual slot tubing

Optional Control Options:

- Somfy Sonesse 50 RTS 230v Mains Powered Motor (Remote Control and App)
- Somfy Sonesse 50 Hardwired Mais Powered Motor (Wall Switch or AV)
- Geiger 4:1 Ratio Gearbox Operation with Crank Winding Handle

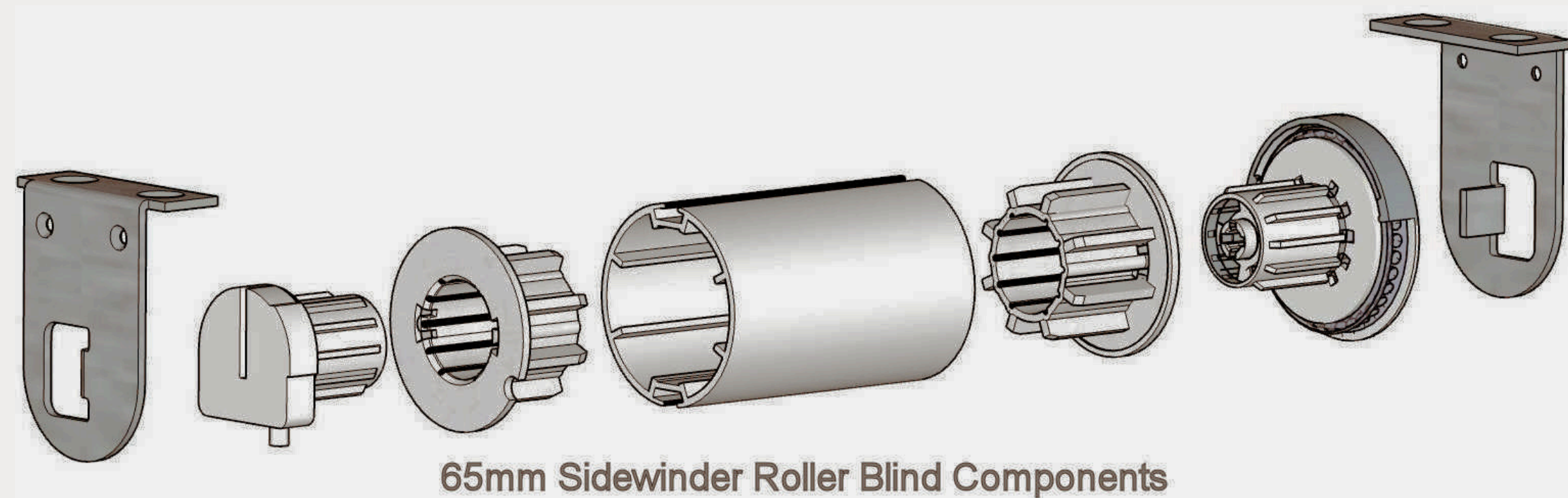

75mm System

Drive End Features:

- The 1:4 geared clutch ensure that this system can cope with up to 12kg of fabric.
- Operated with nickel N° 10 chain
- Internal mechanisms are coated with tailored lubricant ensuring smooth and quiet operation.
- 3 pin secure fitting clicks securely into bracket

Bracket Features:

- Universal Bracket enabling blind to be fitted for under or over hand operation
- Load Capacity 12.0Kg
- Plated for rust resistance
- Plastic cover caps available to finish blinds when fitted outside the recess

Free End:

- Spring loaded plunge design offers flexibility and positive locking into bracket

Roller Tube:

- High Quality 75mm internal webbed extruded aluminium single slot tubing

Optional Control Options:

- Somfy Sonesse 50 RTS 230v Mains Powered Motor (Remote Control and App)
- Somfy Sonesse 50 Hardwired Mais Powered Motor (Wall Switch or AV)
- Geiger 4:1 Ratio Gearbox Operation with Crank Winding Handle

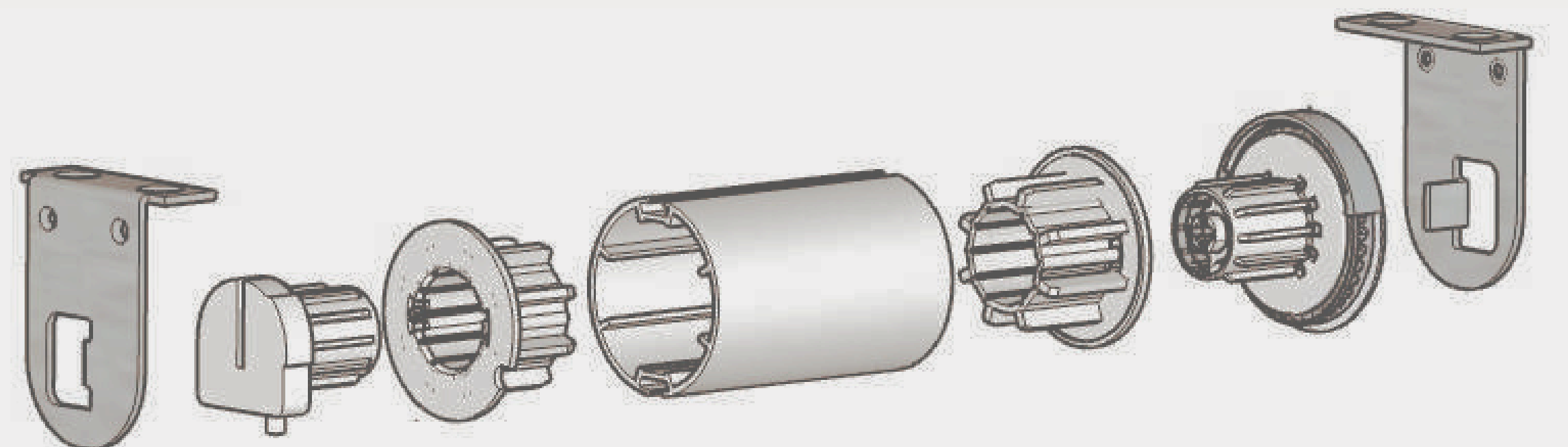

75mm Sidewinder Roller Blind Components

